

**vtech**<sup>®</sup>  
Baby

User's Manual

# Little Friendlies Sweet Dreams



© 2014 VTech  
Printed in China  
91-002848-005 UK

**VTech understands that a child's needs and abilities change as they grow and with that in mind we develop our toys to teach and entertain at just the right level...**

## **vtech** Baby

**Toys that will stimulate their interest in different textures, sounds and colours**

### **I am...**

...responding to colours, sounds and textures

...understanding cause and effect

...learning to touch, reach, grasp, sit-up, crawl and toddle

*Birth-36months*



## **Pre-School**

**Interactive toys to develop their imagination and encourage language development**

### **I want...**

...to get ready for school by starting to learn the alphabet and counting

...my learning to be as fun, easy and exciting as can be

...to show my creativity with drawing and music so my whole brain develops

*3-6years*



## **Electronic Learning Computers**

**Cool, aspirational and inspiring computers for curriculum related learning**

### **I need...**

...challenging activities that can keep pace with my growing mind

...intelligent technology that adapts to my level of learning

...National Curriculum based content to support what I'm learning at school

*4-10years*



To learn more about this and other VTech® products, visit [www.vtechuk.com](http://www.vtechuk.com)

# INTRODUCTION

Soothe your little baby to sleep with the **Little friendlies Sweet Dreams** by **VTECH**®! Develop your baby's senses and encourage first words with this combination ceiling projector and musical cot light. Soft melodies and fun images will help lull your baby to sleep.

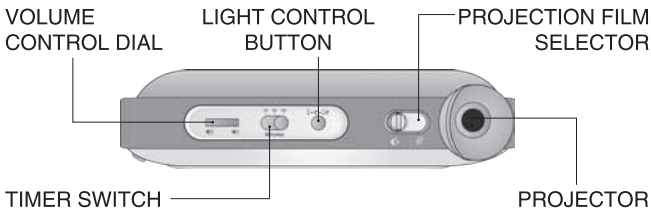

# INCLUDED IN THIS PACKAGE

- One VTech® Little friendlies Sweet Dreams
- 2 cot attachment straps
- One User's Manual

## WARNING:

All packing materials, such as tape, plastic sheets, packaging locks and tags are not part of this toy, and should be discarded for your child's safety.

## NOTE:

Please keep user's manual as it contains important information.

Unlock the packaging locks:

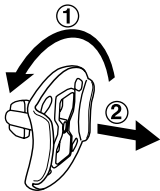

- ① Rotate the packaging locks 90 degrees anti-clockwise.
- ② Pull out the packaging locks.

# INSTRUCTIONS

## BATTERY INSTALLATION

1. Make sure the unit is turned **OFF**.
2. Locate the battery cover on the back of the unit. Use a coin or a screwdriver to loosen the screw.
3. Install 4 new AA (AM-3/LR6) batteries following the diagram inside the battery box. (The use of new alkaline batteries is recommended for maximum performance.)
4. Replace the battery cover and tighten the screw to secure the battery cover.

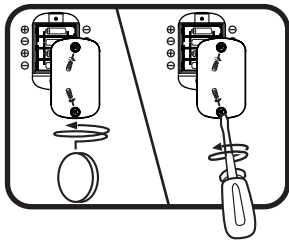

## BATTERY NOTICE

- Use new alkaline batteries for maximum performance.
- Use only batteries of the same or equivalent type as recommended.
- Do not mix different types of batteries: alkaline, standard (carbon-zinc) or rechargeable (Ni-Cd, Ni-MH), or new and used batteries.
- Do not use damaged batteries.
- Insert batteries with the correct polarity.
- Do not short-circuit the battery terminals.
- Remove exhausted batteries from the toy.
- Remove batteries during long periods of non-use.
- Do not dispose of batteries in fire.
- Do not charge non-rechargeable batteries.
- Remove rechargeable batteries from the toy before charging (if removable).
- Rechargeable batteries are only to be charged under adult supervision.

## Disposal of batteries and product



The crossed-out wheellie bin symbols on products and batteries, or on their respective packaging, indicates they must not be disposed of in domestic waste as they contain substances that can be damaging to the environment and human health.

The chemical symbols Hg, Cd or Pb, where marked, indicate that the battery contains more than the specified value of mercury (Hg), cadmium (Cd) or lead (Pb) set out in Battery Directive (2006/66/EC).



The solid bar indicates that the product was placed on the market after 13th August, 2005.

Help protect the environment by disposing of your product or batteries responsibly.

For more information, please visit:

[www.recycle-more.co.uk](http://www.recycle-more.co.uk)

[www.recyclenow.com](http://www.recyclenow.com)

# PRODUCT ASSEMBLY INSTRUCTIONS

With the **VTech® Little Friendlies Sweet Dreams** safety come first. To ensure your child's safety, adult assembly is required. Please follow the below instructions carefully and make sure the final assembly is correct. Attach only to cots with sturdy rails and spindles. Do not attach to cots with mesh walls.

1. Place the unit in the cot bringing both straps over the top rail. Slide the top of the strap under the slot on the back of the unit and secure. Repeat this procedure with the second strap. You can adjust the hanging height by choosing the appropriate hole on the top of each strap.



2. Fasten the cord on the back of the unit to the closest spindle.
3. Pull slightly on the unit to make sure both straps have been securely fastened. The unit should be tight against the cot rail. Please check the unit frequently to ensure it is still secure.

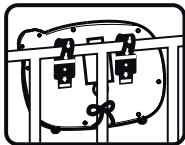

4. The unit can also be used outside of the cot as a floor toy. For your child's safety, please remove the cot attachment straps and store them in a safe location.

# ACTIVITIES

## 1. ON/OFF/MODE SELECTOR SWITCH

Slide the **ON/OFF/MODE SELECTOR SWITCH** to select the Nature Sounds Mode ( 🌿 ), Sing-Along Song Mode ( 🎵 ) or the Melody Mode ( 🎶 ).

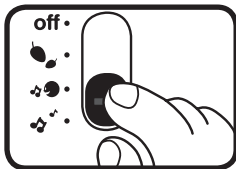

## 2. TIMER SWITCH

Slide the **TIMER SWITCH** to select the length of time the unit will play for. When the time is up the unit will automatically power-down.

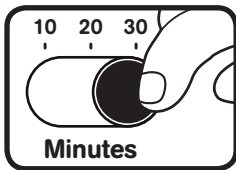

## 3. LIGHT CONTROL BUTTON

Press the **LIGHT CONTROL BUTTON** to select one of four light combinations. Press the button until you find the desired setting.

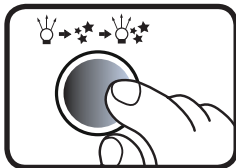

## 4. VOLUME CONTROL DIAL

Turn the **VOLUME CONTROL DIAL** to select the desired volume.

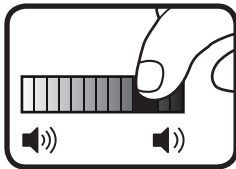



## 5. LEAF BUTTON

Press the **LEAF BUTTON** to play the next nature sound, sing-along song or melody depending on the selected mode.



## 6. PROJECTION FILM SELECTOR SWITCH

Slide the **PROJECTION FILM SELECTOR SWITCH** to change the image that is projected on the ceiling.

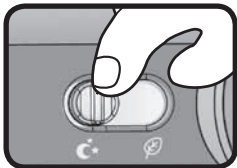

## 7. SOUND SENSOR

The **VTech® Little Friendlies Sweet Dreams** is equipped with a special sound sensor. Once the selected time setting has ended, the unit will automatically power-down. The sensor will reactivate the unit when it detects baby's cry for approximately 4 seconds without interruption. The unit will reactivate according to the selected mode.

## 8. AUTOMATIC SHUT-OFF

To preserve battery life, the **VTech® Little Friendlies Sweet Dreams** will automatically power-down after the selected time. The unit can be turned on again by pressing the leaf button, sliding the mode selector switch or when the sound sensor detects baby's cry.

# SING-ALONG SONG LYRICS

## SING-ALONG SONG 1

The moon is out, the world is still.  
It's time to get tucked in.  
It's time to rest,  
Sleep tight little one,  
All through the night.

## SING-ALONG SONG 2

Twinkle, Twinkle, little star,  
How I wonder what you are.

## SING-ALONG SONG 3

Ring around the rosy,  
A pocket full of posies.  
Hush-a, hush-a,  
We all fall down.

## SING-ALONG SONG 4

Row, row, row, your boat,  
Gently down the stream.

# CARE & MAINTENANCE

1. Keep the unit clean by wiping it with a slightly damp cloth.
2. Keep the unit out of direct sunlight and away from any direct heat source.
3. Remove the batteries when the unit will not be in use for an extended period of time.
4. Do not drop the unit on hard surfaces and do not expose the unit to moisture or water.

# TROUBLESHOOTING

If for some reason the program/activity stops working or malfunctions, please follow these steps:

1. Please turn the unit OFF.
2. Interrupt the power supply by removing the batteries.
3. Let the unit stand for a few minutes, then replace the batteries.
4. Turn the unit ON. The unit should now be ready to play again.
5. If the product still does not work, replace with an entire set of new batteries.

If the problem persists, please call our Consumer Services Department on 01235 546810 (from UK) or +44 1235 546810 (outside UK) and a service representative will be happy to help you.

## IMPORTANT NOTE:

Creating and developing **VTech®** products is accompanied by a responsibility that we take very seriously. We make every effort to ensure the accuracy of the information, which forms the value of our products. However, errors sometimes can occur. It is important for you to know that we stand behind our products and encourage you to call our Consumer Services Department on 01235 546810 (from UK) or +44 1235 546810 (outside UK), with any problems and/or suggestions that you might have. A service representative will be happy to help you.

**CLASS 1  
LED PRODUCT**



## PRODUCT WARRANTY



Thank you for choosing this quality product from VTech. We hope it will bring many hours of entertainment, imaginative play and learning.

1. The product detailed above is covered by a one year warranty from the date of purchase, against any defects in materials or workmanship.
2. The product may be returned to the place of purchase. Alternatively the product can be returned to VTech Electronics Europe plc (see address below), with proof of purchase, without proof of purchase no replacement will be provided.
3. VTech Electronics Europe plc will examine the product and if it is found to be defective due to faulty materials or workmanship, will replace the product at their discretion.
4. If the product covered by this warranty is damaged due to misuse, modification or unauthorised repair, or because of faulty batteries, battery discharge or incorrect electrical connections, then this warranty becomes void.
5. This warranty is personal to the original purchaser and is not transferable.
6. Breakages to the LCD screen are not covered by the warranty.
7. Returns to VTech Electronics Europe plc should include a cheque or postal order for £1.50 towards the cost of return postage and packaging.
8. Products returned to VTech Electronics Europe plc, should be addressed as follows and packed carefully to avoid damage in transit (Please do not include batteries or adaptor).  
Please include details of the fault together with your name and address.

VTech Electronics Europe plc, c/o Tablogix Limited, 200 Milton Park, Abingdon, Oxon OX14 4TA

**THIS WARRANTY IS OFFERED AS AN EXTRA BENEFIT AND DOES NOT AFFECT CONSUMERS' STATUTORY RIGHTS.**

This warranty is valid for the UK and Eire only. For products purchased outside the UK and Eire, please contact your local distributor or place of purchase.

